

## INTRODUCTION

Thank you for purchasing KOBOTIX® REAL RACER™!

REAL RACER™ puts you in the driver's seat and is ready to play right out of the box!  
Follow the instructions in the manual and you will be up and racing in no time!

For the latest full REAL RACER™ Guide, visit [KOBOTIX.COM](http://KOBOTIX.COM).

## WHAT'S INCLUDED

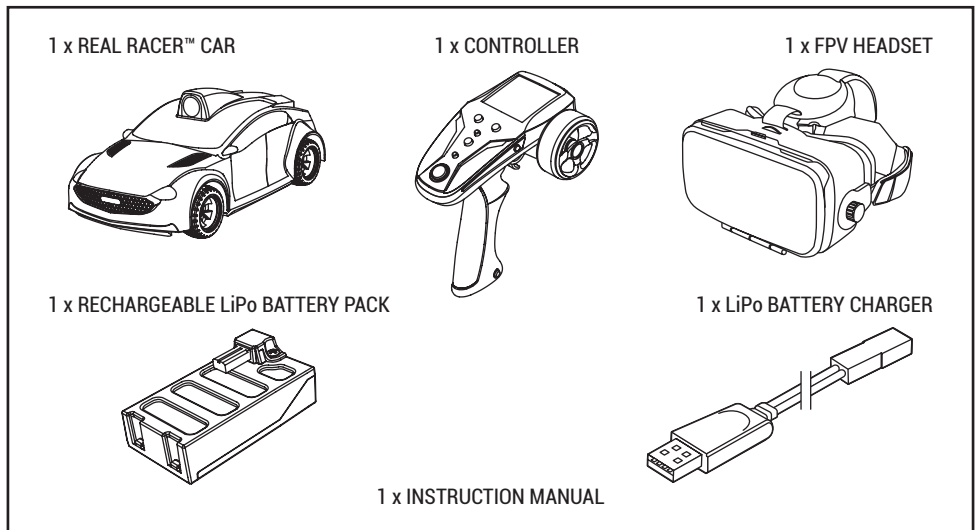

## MANY WAYS TO DRIVE

1. Standard RC racing experience without the app and headset. Your REAL RACER™ is ready to go as soon as the batteries are installed and both the REAL RACER™ Car and Controller are powered ON.
2. With the REAL RACER™ App, experience the driver's view and access the various features of your REAL RACER™.
3. For a fully immersive driver's view experience - launch the REAL RACER™ App, activate the Headset function and strap on the FPV Headset.

### ⚠ CAUTION:

#### HAIR ENTANGLEMENT

Tie back and cover hair and secure loose clothing prior to play.

### ⚠ WARNING:

#### CHOKING HAZARD

This product is not suitable for children under 3 years because of small parts.

# 14+

# KOBOTIX

# POWERING REAL RACER™

## OUT-OF-THE-BOX

The Rechargeable LiPo Battery Pack comes assembled within the Battery Compartment of your REAL RACER™ Car, but initially disconnected and discharged for transportation and safety reasons.

Please follow the steps listed below to access, charge, and connect the battery.

Fully charge the LiPo Battery Pack prior to use (please refer to Page 3 for instructions) and ensure the 4 x AAA batteries (not included) used for the Controller are new.

**Note:** Never pull on the cable when disconnecting the LiPo Battery Pack from the REAL RACER™ Car or the LiPo Battery Charger as it may cause damage that renders them unusable.

Always hold onto the body of the connector when connecting or disconnecting the LiPo Battery Pack.

## INSTALLING THE LiPo BATTERY PACK

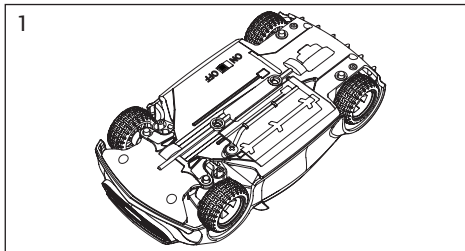

1. Lay the REAL RACER™ Car down so that the Battery Compartment faces upwards.

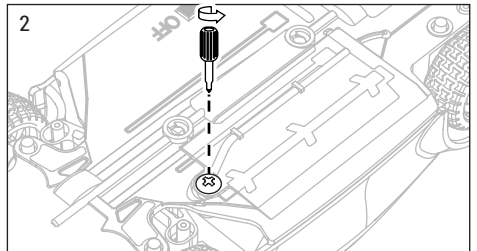

2. Using a Phillips screwdriver (not included), remove the screw on the Battery Compartment Cover.

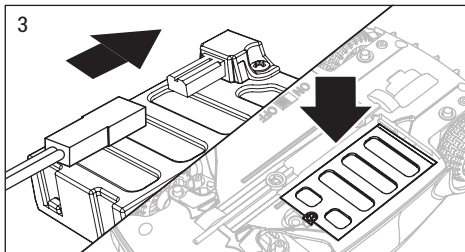

3. Correctly orient and align the connectors and push the plug into the socket on the battery pack (**do not force**), then insert the Rechargeable LiPo Battery Pack (included) into the Battery Compartment.

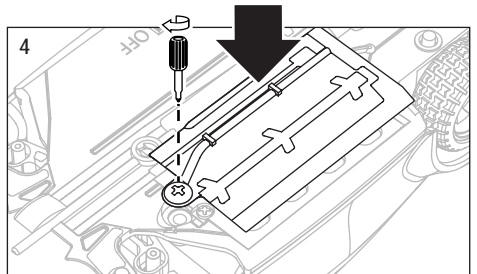

4. Replace the Battery Compartment Cover and tighten screw using the screwdriver. **Do not over-tighten.**

## INSTALLING BATTERIES IN THE CONTROLLER

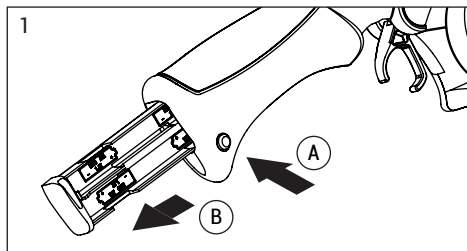

1. (A) Press the button at the bottom of the Controller handle to release the Battery Cartridge.  
(B) Insert 4 x AAA batteries (not included).  
Ensure that the positive and negative polarities match the illustration inside the Battery Cartridge.

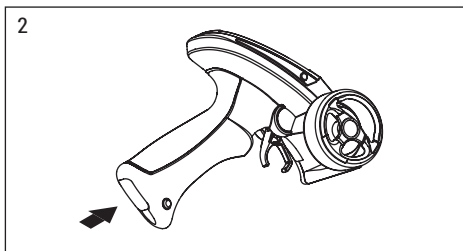

2. Slide the Battery Cartridge back into the Controller until it \*clicks\* into place.

## CHARGING THE LiPo BATTERY PACK

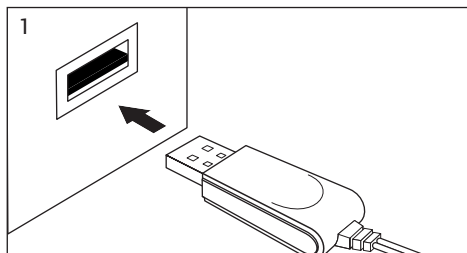

1. Plug the charger into a powered USB outlet (5V 1A rated). The LED will glow GREEN when connected to a USB outlet.

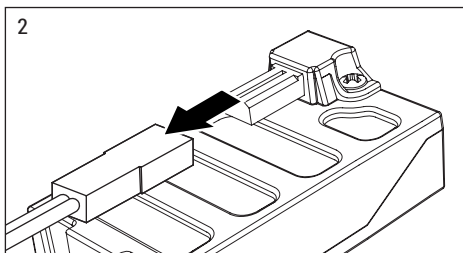

2. Plug the battery connector into the connector on the charger. The LED on the charger will glow RED to indicate charging in progress.

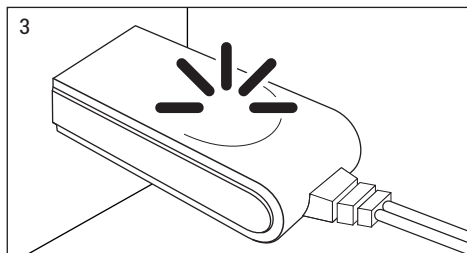

3. When the LiPo battery is fully charged, the charger LED will glow GREEN. Charging time for a fully discharged battery is approximately 75 minutes.

# USING THE REAL RACER™ CAR

## ABOUT THE REAL RACER™ CAR

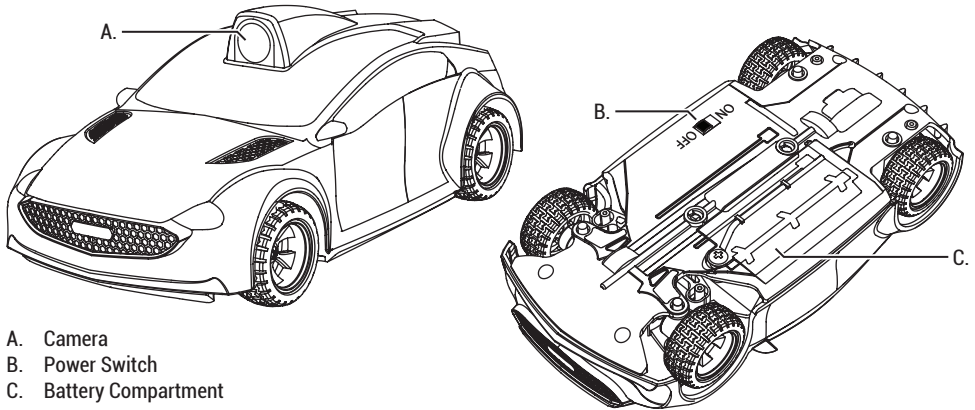

Do not leave the REAL RACER™ Car powered ON and idle. The REAL RACER™ Car will twitch the front wheels and emit an audible warning if it is left idle for 2 minutes.

## TECHNICAL INFORMATION

TRANSMISSION RANGE: Approximately 30 meters (98.4 feet) with direct line of sight.

MAX SPEED: 15 km/h (9.3 mph).

CAMERA: HD 720p 30 FPS.

CONNECTIVITY CONTROL LINK: 2.4 GHz RF.

VIDEO LINK: Wi-Fi 802.11n (2.4 GHz). The video streaming function uses 2.4 GHz Wi-Fi band - signal range and quality may be negatively affected by other 2.4 GHz radio frequency signals, and/or obstacles in the area.

## CHANGING CAR BODY SHELL AND MICRO SD CARD ACCESS

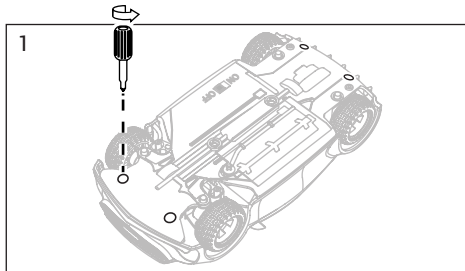

### 1. CHANGING CAR BODY SHELL

Remove the four screws indicated on the underside of car, align new car body shell to chassis and reinstall screws. **Do not over-tighten.**

**Note:** Tampering with screws other than those indicated may void warranty.

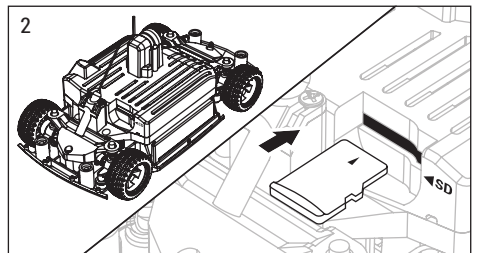

### 2. MICRO SD CARD ACCESS

After removing the car body shell, flip the chassis right-side-up to locate the Micro SD Card Slot (to rear). Correctly orientate and align Micro SD Card, then carefully insert it into the slot. **Do not force.**

# DRIVING REAL RACER™

## ABOUT THE CONTROLLER

The Controller comes in two separate parts consisting of a Controller Body and a Steering Wheel.

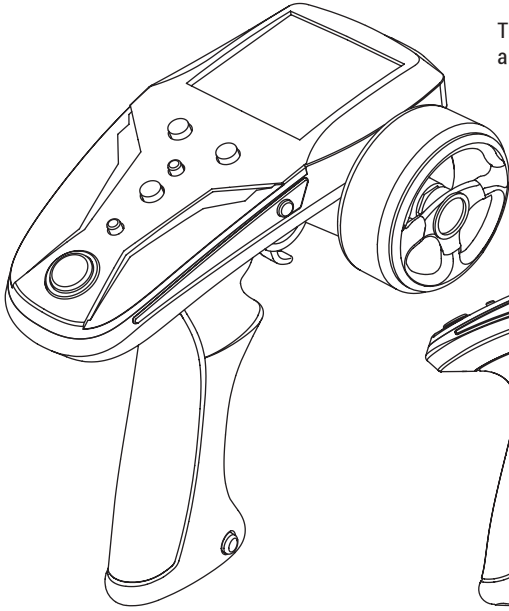

ASSEMBLED CONTROLLER

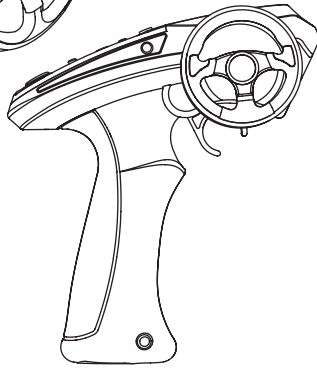

SIDE VIEW

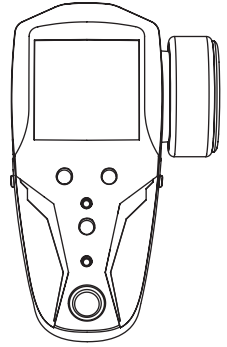

TOP VIEW

## ATTACHING THE STEERING WHEEL

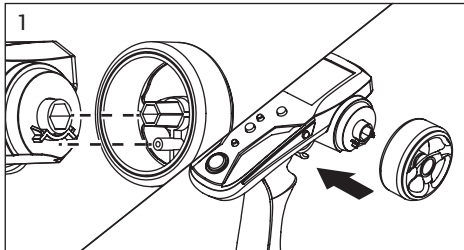

1. Align the hexagonal steering column on the back of the Steering Wheel with the hexagonal steering boss on the Controller, whilst also ensuring that the cylindrical pin beneath the steering column on the Steering Wheel is located within the "M"-shaped area of the steering range endpoints on the Controller body.

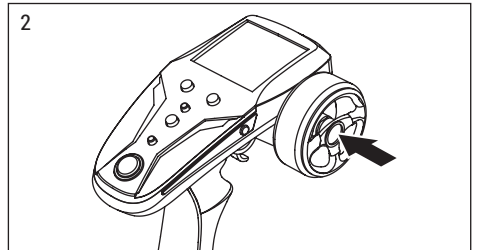

2. Once correct alignment has been achieved, firmly press at the centre of the Steering Wheel to lock it into place.

## STEERING AND THROTTLE

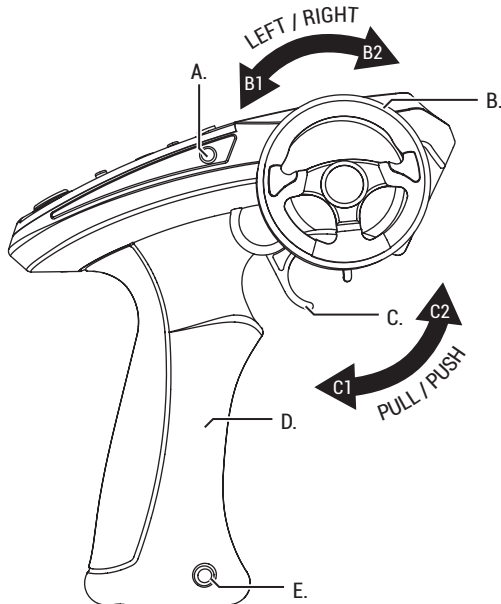

SIDE VIEW

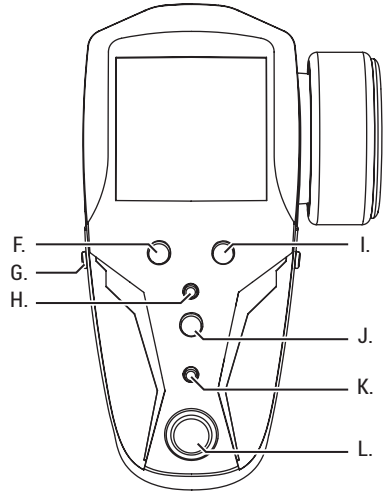

TOP VIEW

- A. Capture Video
- B. Steering Wheel
- C. Throttle
- D. Pistol Grip
- E. Battery Cartridge Release
- F. Steering Rate
- G. Take Picture
- H. Bind
- I. Steering Trim
- J. Throttle Rate
- K. Auxiliary Button
- L. Power Button

## FUNCTIONS

- A. Capture Video: Activates the Video Recording function when the REAL RACER™ App is connected to the REAL RACER™ Car (1st press STARTS recording; 2nd press ENDS recording).
- B. Steering Wheel: B1 steers car to the LEFT; B2 steers car to the RIGHT.
- C. Throttle : C1 accelerates car FORWARD; C2 accelerates car BACKWARDS.
- D. Pistol Grip: Stable and comfortable ambidextrous handle.
- E. Battery Cartridge Release: Press to release Battery Cartridge for installing and replacing batteries.
- F. Steering Rate: Adjust maximum steering angle by turning dial.
- G. Take Picture: Captures a snapshot when the REAL RACER™ App is connected to the REAL RACER™ Car.
- H. Bind: Forms a dedicated link between Controller and a REAL RACER™ Car (please refer to Page 9 for instructions).
- I. Steering Trim: Adjust the center position of front wheels on the REAL RACER™ Car by turning dial.
- J. Throttle Rate: Adjust maximum speed by turning dial.
- K. Auxiliary Button: For custom functions.
- L. Power Button: Activates the Controller.

# THE FPV HEADSET

## ABOUT THE FPV HEADSET

- A. Phone Compartment Release Button
- B. Capacitive Touch Button
- C. Optical Distance Dial
- D. Focal Adjustment Dial
- E. Phone Compartment
- F. Optical Lens
- G. Adjustable Headstrap

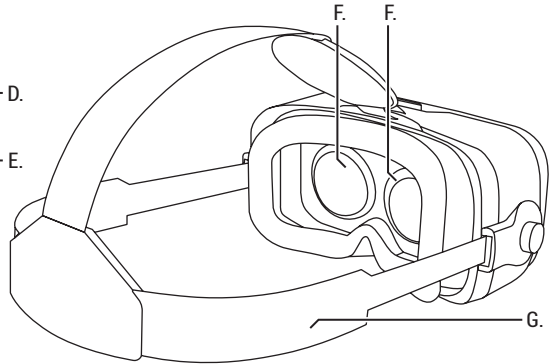
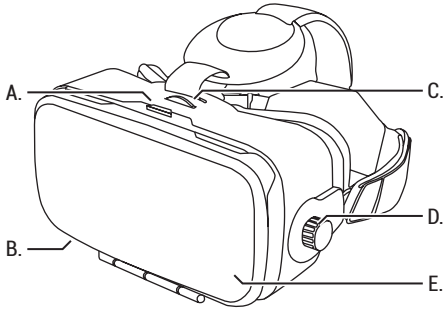

**Note:** The FPV Headset will accept devices up to 165mm x 84mm (6.5" x 3.3").

## WEARING THE FPV HEADSET

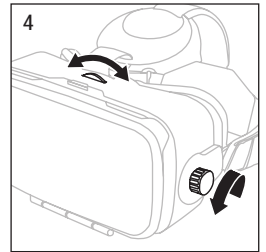
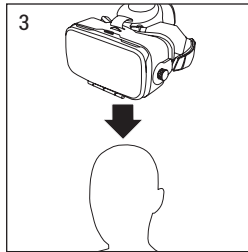
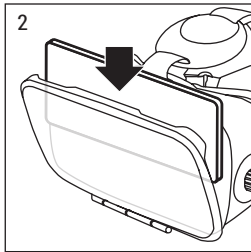

**Note:** Please refer to Page 8 for instructions on downloading the REAL RACER™ App and connecting to your REAL RACER™ Car.

1. Launch the REAL RACER™ App, connect to your REAL RACER™ Car and activate the HEADSET Mode.
2. Open the Phone Compartment on your headset and insert your phone with the screen facing the optical lenses. Close the compartment and make sure that it is securely locked.
3. Wear the headset and adjust straps to make sure it fits your head securely and comfortably.
4. Adjust the optical lenses until you see clearly. The Optical Distance Dial on top adjusts optical spacing and the Focal Adjustment Dials on both sides adjust focus.
5. You are now in the driver's seat. Pick up the Controller and you are ready to race!

# THE REAL RACER™ APP

## DOWNLOADING THE REAL RACER™ APP

Please check if your device is compatible with the app.

Download the REAL RACER™ App on your smart device. Follow the QR codes below for direct links or search for "KOBOTIX REAL RACER" on Google Play™ or the App Store®.



**DEVICE LIST**  
[kobotix.com/devices](http://kobotix.com/devices)



## CONNECTING TO THE REAL RACER™ CAR

Ensure that the LiPo battery is charged and your REAL RACER™ Car is turned ON.

With Wi-Fi enabled on your smart device, launch the REAL RACER™ App.

On most devices, the REAL RACER™ App will automatically connect to your REAL RACER™ Car.

For full details, launch the REAL RACER™ App and follow the on-screen instructions.

## FACTORY RESETTING YOUR REAL RACER™ CAR

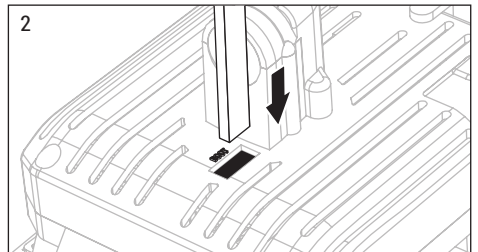
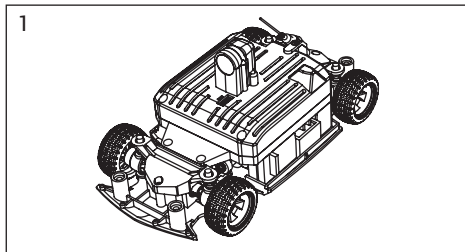

1. Turn ON your REAL RACER™ Car and after removing the car body shell (please refer to Page 4 for instructions), flip the chassis right-side-up to locate the BOOT Button Slot (to front).
2. Insert a small, sturdy, blunt, non-metallic object into the BOOT Button Slot and gently press downwards for 5 secs. **Do not force.** The red status LED will blink rapidly for 3 seconds, then go off. Once the status LED is off, switch the car OFF, then back ON again. The Wi-Fi password will be reset to "12345678".



# CONTROLLER BINDING

## BINDING THE CONTROLLER TO ANOTHER REAL RACER™ CAR

Your REAL RACER™ Car and Controller are paired straight out of the box. In case you need to manually pair your car and Controller, or you want to pair your Controller to a different car, please follow these instructions:

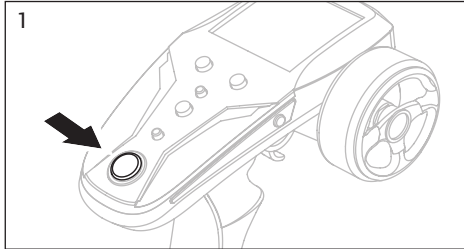

1. Turn ON your REAL RACER™ Controller.

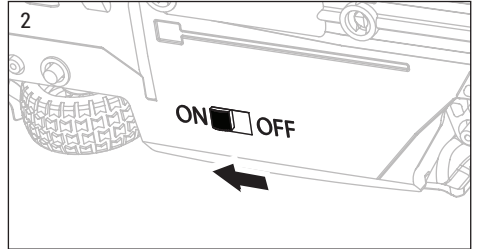

2. Turn ON your REAL RACER™ Car.



3. Start the REAL RACER™ App and connect to your car.

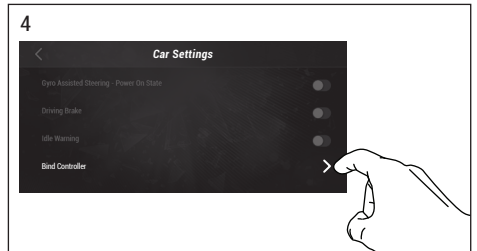

4. Initiate pairing by navigating to Settings > Car Settings and press Bind Controller.

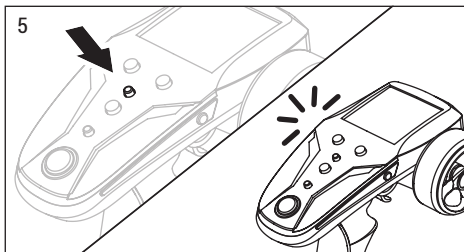

5. Press the Bind button on the Controller.

The LEDs on the REAL RACER™ Controller will flash slowly whilst pairing, then blink rapidly 3 times to indicate successful pairing with a REAL RACER™ Car.

# SAFETY PRECAUTIONS & WARNINGS

## OPERATING REAL RACER™

- Do not immerse REAL RACER™ or any parts in water or any other form of liquid.
- Do not drop, throw, or kick the REAL RACER™ Car as this may damage mechanical functions.
- Do not operate in direct sunlight.
- Do not operate on fine loose surfaces which may get stuck inside and damage car.
- Keep hands, hair and loose clothing away from the wheels when Power Switch is turned ON.
- Keep all chemicals, small parts and anything electrical out of the reach of children.
- Keep moving parts clean.
- Keep parts dry.
- Always let parts cool after use before touching.
- Turn off Controller and car when not in use.
- Parental guidance is recommended.
- Users should keep strict accordance with the instruction manual while operating the product.
- The product must only be used with the supplied Controller.

## LITHIUM-ION POLYMER BATTERY CAUTIONS

The product contains a 3.7V/800mAh lithium-ion polymer (LiPo) battery. LiPo batteries have a severe risk of fire and injury if they are improperly handled or misused.

Read the following precautions and instructions carefully:

- Remove LiPo battery from the product before charging.
- Keep LiPo battery away from any flammable materials.
- Never charge the LiPo battery unattended at any time. When charging the LiPo battery, remain in constant observation of the process and react immediately to any potential problems.
- Do not expose LiPo battery to extreme heat or fire; battery may leak or explode.
- Do not short-circuit the supply terminals of the LiPo battery.
- Do not drop or subject LiPo battery to strong impact.
- Do not allow the LiPo battery to get wet.
- Only charge the LiPo battery under adult supervision.
- Only charge the LiPo battery with the included charging cable.
- Only charge the LiPo battery when needed - leaving the LiPo battery fully charged will damage the battery.
- Ensure LiPo battery is discharged before storing REAL RACER™.
- Dispose of LiPo battery properly at a designated local battery recycling facility.

## ALKALINE BATTERY CAUTIONS

- New alkaline batteries are recommended for use in Controller.
- Replacement of batteries must be done by adults.
- Follow the polarity (+/-) diagram in the battery compartment.
- Remove exhausted batteries from the product.
- Do not mix old and new batteries, different types of batteries (Carbon-Zinc, Alkaline or rechargeable) or rechargeable batteries of different capacities.
- Do not dispose of batteries in fire, as batteries may explode or leak.
- Do not recharge non-rechargeable batteries.
- Do not short-circuit the supply terminals.
- Remove batteries from the product when it is not being used for a long period of time.
- Dispose of used batteries properly.

 **WARNING:** Batteries are harmful if swallowed. Please keep away from children.

## **FPV HEADSET CAUTIONS**

- Remain stationary and do not wander when wearing the FPV Headset to prevent injury.
- Always be aware of your surroundings when wearing the FPV Headset.
- Do not handle sharp or otherwise dangerous objects while using the FPV Headset.
- Do not leave the FPV Headset in the sun when not in use. This could damage your phone.
- Do not expose or point the camera on the REAL RACER™ Car towards the sun or other direct light source whilst using the headset. This could result in personal injury, especially ocular.
- Do not use the FPV Headset when you are tired or sleep-deprived, or under the influence of alcohol or drugs.
- Do not use the FPV Headset when you are suffering from headaches or digestive problems.
- Stop using the FPV Headset if anyone using the FPV Headset experiences discomfort or any of the following symptoms: dizziness, disorientation, loss of awareness, pain in the head or eyes, motion sickness, seizures.

## **OVERHEATING**

The REAL RACER™ Car may start to overheat if operating under high temperature conditions, or if left idle for an extended period of time. The car will automatically go into low-power shut down if an overheat condition is detected. Switch OFF your REAL RACER™ Car at the power switch and let it cool down to room temperature before playing again.



Contains 1 x 3.7V/800mAh LiPo battery pack and requires 4 x 1.5V AAA batteries (not included). Batteries or battery packs must be recycled or disposed of properly. Protect the environment by not disposing of this product with household waste [2012/19/EU]. Check your local authority for recycling advice and facilities.

## **WARRANTY**

This product is warranted to the original purchaser to be free from defects in material or workmanship for a period of 180 days from the date of the original purchase. For consumers who are covered by consumer protection laws or regulations in their country of purchase or, if different, their country of residence, the benefits conferred by this warranty are in addition to all rights and remedies conveyed by such consumer protection laws and regulations.

The warranty covers against manufacturing defects. It does not cover abuse, alteration, theft, loss, unauthorized and/or unreasonable use, or normal "wear and tear." During the warranty period, The Product Workshop Ltd. will make sole determination of a defect. If The Product Workshop Ltd. determines a defect, The Product Workshop Ltd., at its sole discretion, will repair or replace the defective part or product with a comparable part.

This does not affect your statutory rights. For full details, safety updates, or support, see [kobotix.com/contact](http://kobotix.com/contact).

## **FCC & IC STATEMENT**

This device complies with Part 15 of the FCC Rules. Operation is subject to the following two conditions:

(1) This device may not cause harmful interference, and (2) this device must accept any interference received, including interference that may cause undesired operation.

This equipment has been tested and found to comply with the limits for a Class B digital device, pursuant to Part 15 of the FCC Rules. These limits are designed to provide reasonable protection against harmful interference in a residential installation. This equipment generates, uses and can radiate radio frequency energy and, if not installed and used in accordance with the instructions, may cause harmful interference to radio communications. However, there is no guarantee that interference will not occur in a particular installation. If this equipment does cause harmful interference to radio or television reception, which can be determined by turning the equipment off and on, the user is encouraged to try to correct the interference by one or more of the following measures:

- Reorient or relocate the receiving antenna.
- Increase the separation between the equipment and receiver.
- Connect the equipment into an outlet on a circuit different from that to which the receiver is connected.
- Consult the dealer or experienced radio/TV technician for help.

This device complies with Industry Canada licence-exempt RSS standard(s). 1. Operation is subject to the following two conditions: (1) this device may not cause interference, and (2) this device must accept any interference, including interference that may cause undesired operation of the device. 2. Changes or modifications not expressly approved by the party responsible for compliance could void the user's authority to operate the equipment.

CAN ICES-3(B)/NMB-3(B)

The logo for KOBOTIX, featuring the word "KOBOTIX" in a bold, white, sans-serif font inside a black, rounded rectangular shape with a slight 3D effect.

© 2019 The Product Workshop Ltd. All rights reserved.

REAL RACER™ & KOBOTIX®, and the REAL RACER™ & KOBOTIX® logos are registered trademarks of The Product Workshop Ltd.

Unit 1303A, Henley Industrial Centre,  
9-15 Bute Street, Mong Kok, Kowloon, Hong Kong.

App Store® is a service mark of Apple Inc.

Android™ and Google Play™ are trademarks of Google Inc.

Wi-Fi is a registered trademark of Wi-Fi Alliance®.